

STERILIZER SOLUTION

MIURA



MIURA RQ-50E

VACUUM BOILING WASHER

Miura RQ-50E adalah perangkat vacuum boiling washer yang mengutamakan kepraktisan, keamanan dan efisiensi selama pencucian.

Miura RQ-50E hadir dengan dua teknologi inovatif yang menjadi solusi bagi permasalahan yang sering terjadi pada proses pencucian konvensional, yaitu: Teknologi pembersih kontaminasi eksternal (air injection for bumping) dan teknologi pembersih kontaminasi internal (air injection for rapid vacuum cancellation).

Fitur-fitur unggulan lain dari Miura RQ-50E:

1. Pengoperasiannya tidak membutuhkan nozzle khusus ataupun rak sehingga mempersingkat proses persiapan pencucian.
2. Semua barang bisa dicuci secara bersamaan dengan kualitas hasil pencucian yang sama, apapun tipe barangnya, seperti: laparoscopic forceps, breathing bag, tube, suction tube dan micro surgical instruments.

SPESIFIKASI

Item	RQ-50E
Specification	Standard (mixing valve specification)
External dimensions Width	1,340 × Depth 810 (door open 835) × Height 1,050 (door open 1,570) mm
Effective internal dimensions of the bath	Width 623 × Depth 540 × Height 156 mm
Mass	360 kg (operating 440 kg)
Power supply	3-phase 200 V (50 A residual current operated circuit-breaker with integral overcurrent protection (RCBO)) Rated capacity: 14.93 kW
Water supply facilities	20 A piping (SUS or SGP-VP with a valve) 0.15 to 0.45 MPa 23 L/min or more 30 °C or less (not frozen)
Hot-water supply facilities	20 A piping (SUS or CUT with a valve) 0.15 to 0.45 MPa 20 L/min 80 °C or less at the equipment inlet
RO water facilities (option)	20 A piping (SUS with a valve) 0.15 to 0.45 MPa 20 L/min 50 °C or less at the equipment inlet
Wastewater facilities	32 A piping (SGP) Natural drainage 60 L/min No back pressure Maximum wastewater temperature 93 °C
Exhaust steam facilities	20 A piping (SGP) 80 kg/h or more No back pressure
Operation monitor display	Color liquid crystal graphics display
Cleaning finished notification	Buzzer and message
Tank material	Stainless steel SUS304
Vacuum pump	0.75 kW
Plumbing	Automatic
Washing course	Choice of 7 courses
Washing mode	Prewashing, 1st wash (at all times), 2nd wash, 1st rinse (at all times), 2nd rinse, 3rd rinse, draining (at all times) (prewashing, 2nd wash, 2nd rinse and 3rd rinse can be selected for all courses)
Liquid volume	80 L (Effective washing volume: 50 L)

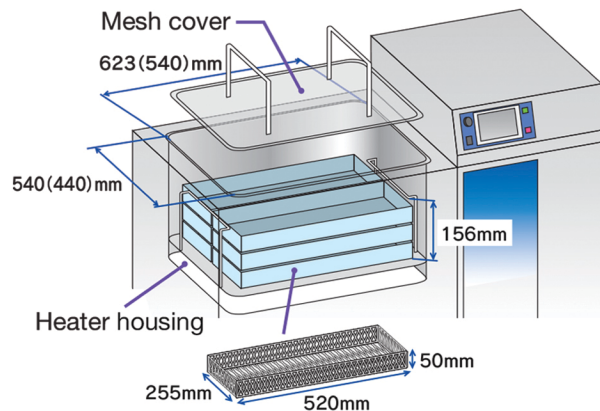

※ Figures in brackets are interior dimensions excluding the corners.

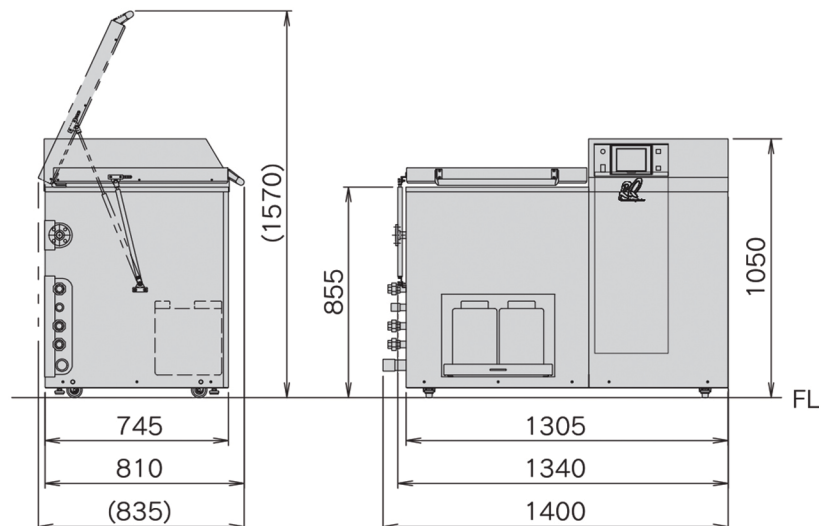

MIURA RL-SERIES

SYSTEM DRYER

Miura RL-Series adalah perangkat system dryer dengan pengoperasian yang sangat mudah, hemat ruang dan dilengkapi dengan fitur kipas terbesar di kelasnya. Volume udara yang tinggi dan fitur pengaturan temperatur memungkinkan untuk pengeringan berbagai macam objek secara bersamaan dengan waktu penyelesaian yang lebih cepat.



Pemasangan selang pengeringan dapat dilakukan dalam tiga langkah mudah:



Tarik rak keluar ke depan.



Pasang selang di slot.



Kembalikan rak ke posisi semula.

Rak dari stainless steel yang bisa diatur dengan interval 25 mm.



Effective volume	520L
Number of insertion holes	64
Connectable diameters	φ 2 to φ 30 mm
Number of shelves	Up to 25

SPESIFIKASI

Item		Unit	RL-500	RL-500W
Door type		—	Single door	Double door
Assembly dimensions	Width	mm	850	
	Depth ※1		675 (door open dimension: 330)	
	Height		1,840	
Chamber internal dimensions	Width	mm	640	
	Depth		600	
	Height		1,600	
Chamber capacity		L	520	
Assembly mass		kg	200	210
Plant	Power(200 V, 3-phase)	kW	3.5	
	Exhaust duct	mm	φ50 ※2	
Material	Drying chamber	—	Stainless steel	
	Door	—	Interior:Stainless steel Exterior:SPHC + baking coating	
	Window	—	Polycarbonate	
Number of loadable items ※3	Basket ※4	—	25	
	Tube ※5	—	192	
	Corrugated tube	—	64	
	Respiratory bag ※6	—	20	
Drying method		—	Hot air circulation type	
Heating method		—	Electric	
Drying temperature setting		°C	45 to 90 (1°C increments)	
Exhaust gas temperature		°C	90 or less	
Timer setting		min.	1 to 900 (1 minute increments)	
Door opening/closing method		—	Manual double doors	
Filter	Main filter	—	HEPA filter	
	Pre-filter	—	Coarse dust filter	
Standard accessories	Shelf ※7	—	7	
Optional extras	—	—	Additional shelf	
	—	—	Respiratory bag jig	



Additional shelf



Respiratory bag jig

RL-500

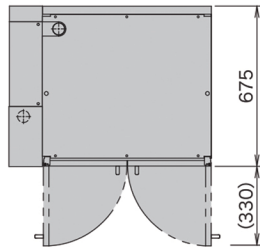

RL-500W

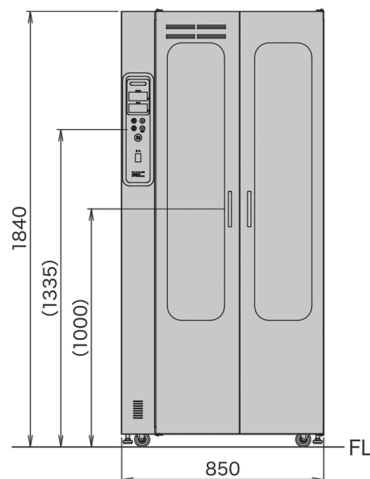
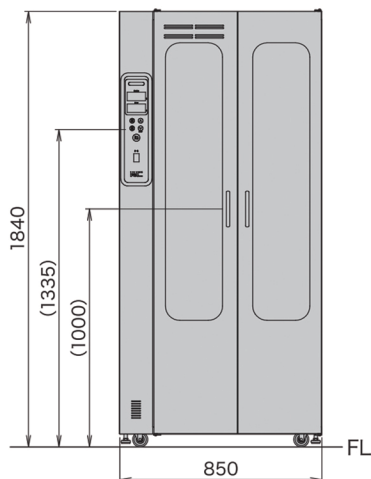
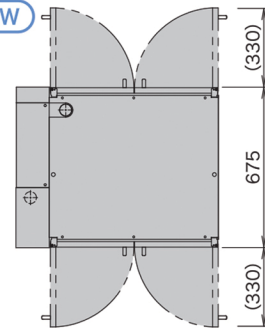

MIURA RK-SERIES

HIGH PRESSURE STEAM STERILIZER

Miura RK-Series adalah perangkat steam sterilizer bertekanan tinggi yang ditujukan untuk sterilisasi material yang sudah melewati proses washer dan sudah di-packing. Berikut adalah fitur-fiturnya.

Emergency Stop Switch

Untuk menghentikan mesin secara aman dalam keadaan darurat.

Touch-screen

Layar sentuh 5.7 inci.

USB Port

Untuk penyimpanan data di media eksternal.

Low Energy

Miura RK-E dilengkapi dengan electric heater steam generator yang dapat mengurangi penggunaan energi.

Space Saving

Miura merancang perangkat RK sepraktis dan seefisien mungkin untuk menghemat tempat penyimpanan.

Build-in Water Softening Cartridge

Setiap perangkat Miura RK-E sudah dilengkapi dengan water softening cartridge.

Automatic Vertical Sliding Door

Pintu otomatis ini tidak memiliki permukaan panas dan dilengkapi dengan sensor yang bisa mencegah tangan terjepit.

Shelf

Dua rak geser dari materi stainless steel telah disediakan bersama perangkat.

Validation Nozzle

Untuk validation control.

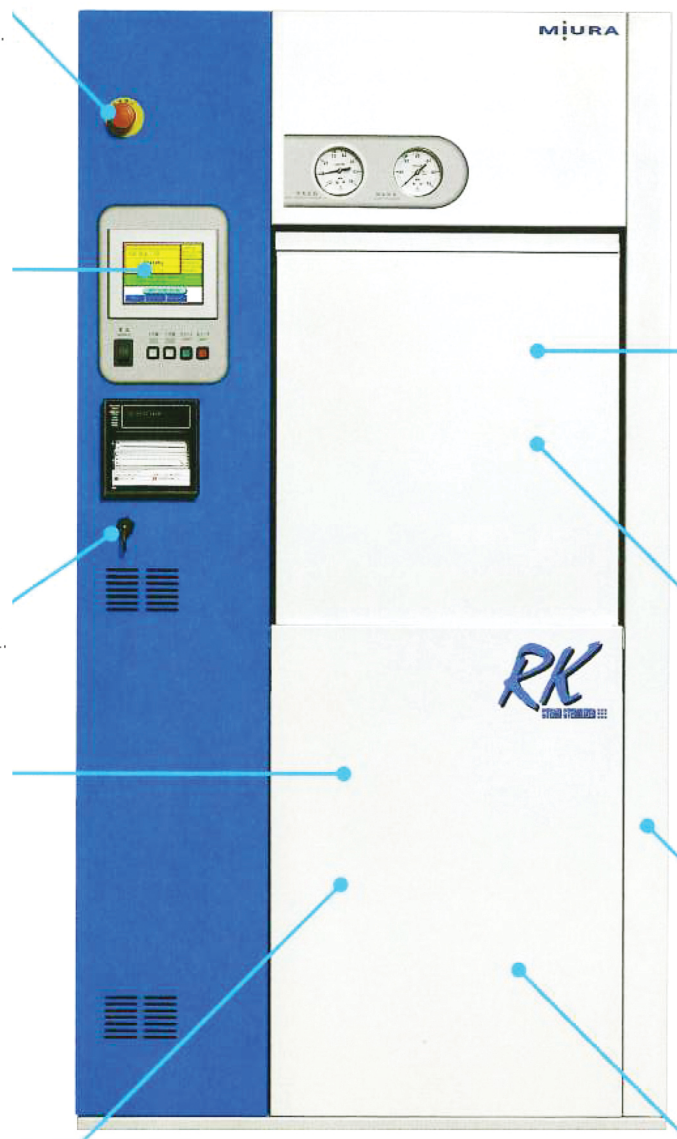

SPESIFIKASI

RK type Specification				
Item		Unit	RK-8EH	RK-8EHW
Steam supply		—	Electric boiler type	
Standard		—	Class 1 pressure vessel	
Pressure vessel		—	Inner chamber/Jacket:Stainless steel	
Maximum working pressure	Inner chamber	MPa	0.27	
	Jacket		0.27	
Normal working pressure		MPa	0.22	
Storage		—	Shelf	
Door plate		—	SUS304 + reinforcement (SS400)	
Door locking mechanism		—	Automatic vertical sliding type	
Inner Chamber dimensions	Width	mm	505	
	Height		505	
	Depth		927	952
Overall dimensions	Front panel	mm	900(Width) × 1,690(Height)	
	Maximum width		1,000	
	Total height		1,770	
	Total depth		1,350	1,255
Overall mass		kg	850	900
City water supply volume		L/min	6~8	
Required feed water pressure		MPa	0.15~0.25(With water flowing)	
Power supply 3ΦAC200V		kW	17.12	
Power supply earth leakage breaker		A	60	
Piping diameter	Feed water inlet	A	15	
	Overflow outlet		15	
	Steam/water outlet		25	
	Safety valve		25×2	

- *1. RK-8EHW is double-door types.
- *2. Ensure that the drain is not subject to back pressure.
- *3. Ensure that the safety valve is not subject to back pressure.
- *4. With the RK-E, ensure that the overflow pipe is not subject to back pressure.
- *5. The RK-E is equipped with a water softening cartridge for making soft water and it must be replaced periodically according to the hardness of the supply water and frequency of operation.

- *6. The following conditions apply to the environment of use.
 Ambient temperature:Machine room side...0~50℃(No freezing)
 :Operation room side...0~30℃(No freezing)
 Relative humidity.....20~90%RH(with no condensation)
 Atmospheric pressure...95~105kPa
 Maximum altitude.....2000m

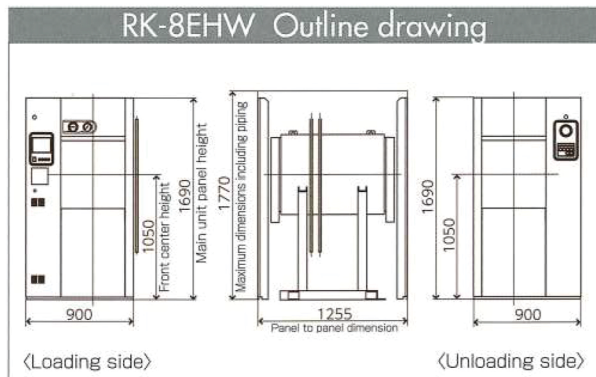
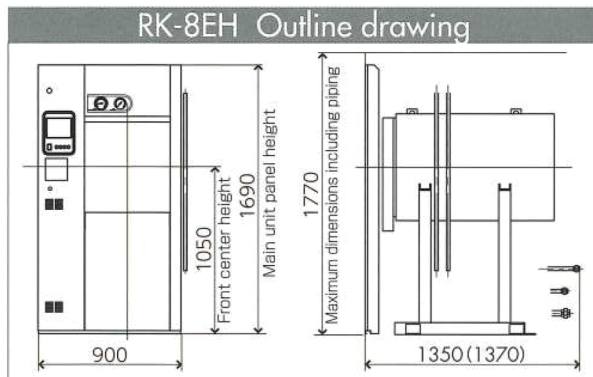

MIURA EQ-240 SERIES / AJ-200

ETHYLENE OXIDE GAS STERILIZER / ABATOR

Miura Ethylene Oxide Gas Sterilizer EQ-240 Series adalah sebuah alat sterilisasi peralatan medis yang beroperasi menggunakan gas ethylene oxide (EO) dan bisa bekerja pada temperatur rendah yang dapat menurunkan resiko berbahaya bagi operator dari ekspos gas EO. Produk EQ-series terdiri dari dua tipe, yaitu EQ-240 (single door) dan EQ-240W (double door).

Miura juga merekomendasikan produk Ethylene oxide gas abator AJ-200 yang hadir dengan desain ringkas dan sesuai dengan standard Jepang. Produk AJ-200 ini berfungsi untuk mengubah sisa-sisa gas EO hingga 99.9% dari perangkat sterilizer menjadi uap air dan karbondioksida yang tidak berbahaya.



AJ-200



EQ-240W

SPESIFIKASI

Item	Model	Unit	EQ-240 type	
			EQ-240	EQ-240W
Vessel construction		—	Stainless steel, square construction	
Door	Type	—	Single-door	Double-door
	Structure	—	Stainless steel, swing opening and closing	
Safety device		—	Closed door checking sensor, door handle locking device, locked door checking switch	
Inner chamber dimensions	Width	mm	500	
	Height	mm	500	
	Depth	mm	903	906
	Capacity	m ³	0.225	
Number of cartridges used		—	3	
Number of loadable baskets		—	Upper2, Lower1	
Loading	Effective basket dimensions (W×H×D)	mm	Upper 445×200×420	
			Lower 445×240×860	
Overall dimensions	Width	mm	800	
	Height	mm	1,515	
	Depth	mm	1,110	1,160
Assembly mass		kg	305	320
Volume of water stored		mL	3,000	
Required plant piping diameter	Exhaust gas outlet	A	20*	
Power supply	200 VAC, single-phase	kW	2.35	

